

spinder
DAIRY HOUSING CONCEPTS

Resting



february 2021

Product catalogue

The benefits of comfort



Spinder since 1973

Tjip Spinder started manufacturing and selling dividers and feed fronts in 1973, using the name Spinder Stalinrichting. What started as a metal workshop, quickly became a small factory and eventually grew into Spinder as we know it today: a leading, advanced manufacturing company with a modern range for contemporary dairy farms.

Tjip Spinder was a real all-rounder and expected the same from his employees. "You were given an overall and a task and that was it", says Dick van der Meer, employee since the start and now co-foreman in the assembly department. With the ink barely dry on his technical school diploma, he went to see Tjip Spinder in 1973 to ask if there was work for him and was told he could start immediately. "Tjip set high standards. Not just for commitment and quality, but also for behaviour. But he didn't go easy on himself either. He was the first to arrive at work at six in the morning and he would only go home late at night when his wife decided that enough was enough and came to fetch him. They lived next door to the workshop."

Spinder has always responded to developments in dairy farming. As livestock increased, so did manufacturing and the range changed along with the requirements and insights of farmers. Especially in the 70s and 80s of the last century, the period that farmers opted for cubicle systems en masse, Spinder experienced considerable growth.

Spinder's growth during the early years was mostly thanks to two good friends of Tjip, who both owned a construction company. They were barn builders and introduced Spinder when the barns they built also needed equipment. When son Pieter took the

reins, he made some changes and implemented innovations. This caused a large improvement in efficiency. It was no longer expected that everyone could do 'everything': the work was divided over various departments. After Pieter, who went to Canada to run a farm, Spinder ceased to be a family-run company in 1995 and was taken over by management. The company is still owned by the board.

Production manager Sjouke van der Meer joined Spinder in 1981. Like Dick van der Meer, he has seen many changes within the company: "Highlights, growth, less successful periods, changes to management, product innovation, you name it. But one thing has remained unchanged and that's the commitment of all colleagues to Spinder. Although Spinder hasn't been a family-run business since 1995, it still feels like family here. And just like in 1973, the bar is still set high. Everything that leaves these premises is of absolute top quality. We are proud of that and that's what we work for, together."

In 2017 Spinder acquired the BUC brand, specialist in dual waterbeds.

As market dynamics are demanding Spinder has had a new premises build, fully in operation from 2020.

Resting

- Freestall divider model 'Profit' 1.1
- Freestall divider model 'Comfort-NG' 1.4
- Freestall divider model 'Comfort' 1.6
- Freestall divider model 'Cosmos' 1.7
- Deep litter freestalls 1.9
- Waved neck bar 1.10
- PE retaining knee rail 1.11
- Meadow Next mattress 1.12
- Waterbeds 1.13
- Studded rubber mat 1.16
- Accessories and fittings 1.17

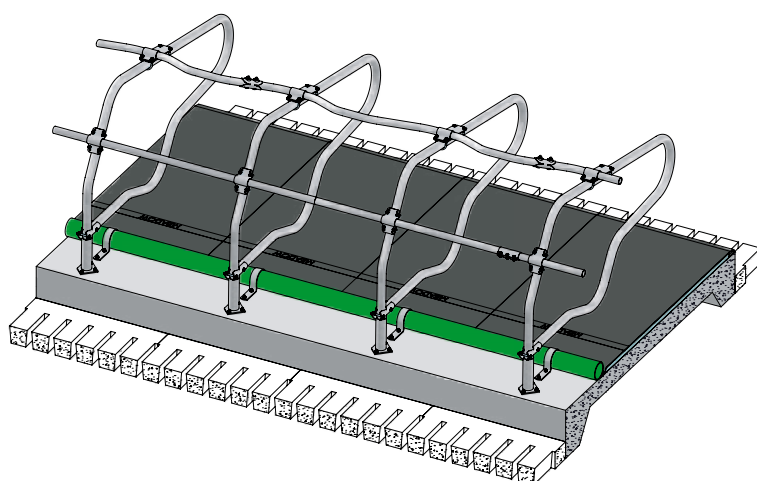

Mounted freestall divider model 'Profit' for cows

Freestall divider	Profit 190	Profit 206	Profit 216
Measurements wall row (cm)			
220-230	x		
230-240		x	
240-260			x
260-270	x		
270-280		x	
>280			x
Measurements single row (cm)			
220-230	x		
230-240		x	
>240			x
Measurements double row (cm)			
430-460	x		
460-480		x	
>480			x

The combinations of the measurements of the stall floor and the model of freestall divider are established to create the maximum space for the animal. Also these measurements prevent from creating precarious room between a wall and a row of dividers.

Freestall divider model 'Profit'

Spinder introduced the freestall divider model 'Profit' in 1996. During all these years the 'Profit' has been applauded for its simple, sturdy construction, its general applicability and the fact that it is so easy to install. But the most important feature of this model is that the 'Profit' offers excellent cow comfort. And, as the result of the unique design, this divider positions the animals in a straight line in the stalls. Therefore the animals stay much cleaner.

General applicable

The freestall divider model 'Profit' is mounted "freely" onto the stall floor. Meaning that it is not attached to any support posts or barn supports. The model 'Profit' for cows is produced in 3 lengths: 216, 206 and 190 cm. Therefore this model is suitable for every situation, new buildings or renovations. One can select the ideal combination of divider length / stall floor length, and achieve the correct position.

Easy to install

The 'Profit' divider is mounted to the concrete floor with a solid foot piece. This foot piece is made of a heavy gauge tubing Ø70 mm (thickness 4 mm), welded on a heavy plate. After mounting the foot piece, the divider, Ø60 mm, is placed loose in the foot piece. By mounting the waved neckbars and head rails appropriately, an extremely stable construction is created.

Allows for a broad range of matting

The open space under the dividers and the far to the front position of the foot piece, allows for easy fitting of almost all kinds of matting. The dimensions of the 'Profit' divider and foot piece are designed for application of the waterbeds, Dunlomat, or a thin layer of loose bedding. When applying the Spinder Meadow matress one has to make use of a filling ring to elevate the divider.

Important advantages:

- Optimal resting comfort due to careful design;
- Durability, due to the suspended construction;
- Quick and easy to install;
- All the right dimensions are available;
- Allows for all types of matting materials.

01.10.513 / 01.10.510 / 01.10.500

Model 'Profit' 216 / 206 / 190
for cows

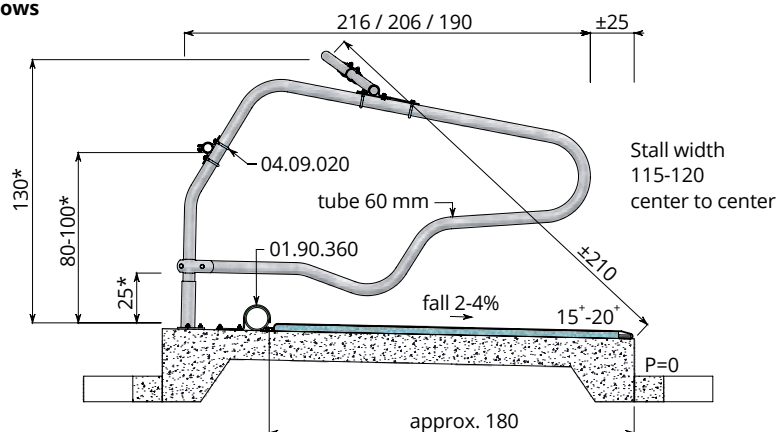

01.10.500

Model 'Profit' 190
for heifers 18-22 months

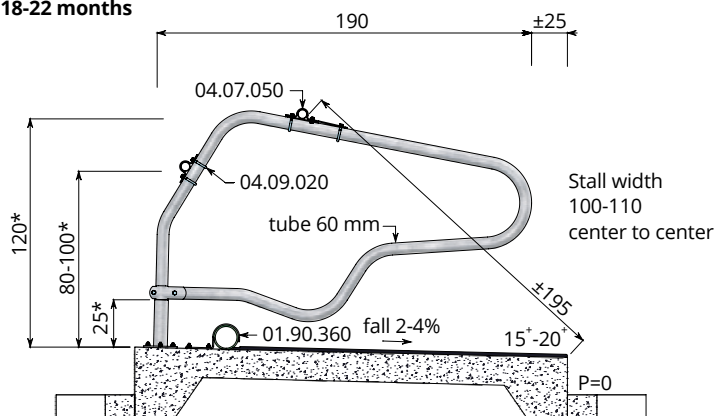

01.10.520

Model 'Profit' 175
for heifers 10-18 months

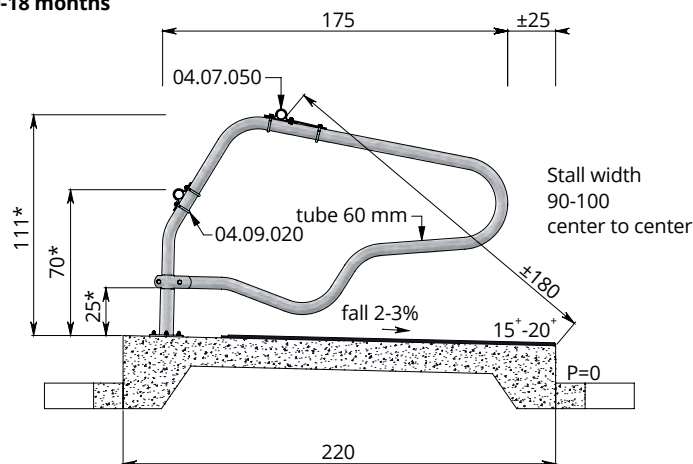

Freestall divider model 'Profit' for cows and heifers
(mounting support piece and T-clamp included)

- 01.10.513 Freestall divider model 'Profit' 216 for cows
- 01.10.510 Freestall divider model 'Profit' 206 for cows
- 01.10.500 Freestall divider model 'Profit' 190 for cows
- 01.10.520 Freestall divider model 'Profit' 175 for heifers

Fittings

- 04.07.050 Shoulder rail strap clamp 48 x 60 mm
- 04.09.020 Strap clamp 48 x 60 mm
- 11.11.240 Floor anchor M12 x 106 (3 per divider)
- 11.12.012 Chemical anchor M12 (10 anchors), an alternative to floor anchor
- 10.15.600 Tube 48 mm, length 6 m
- 04.21.015 Tube clamp coupling 48 mm
- 04.24.015 End coupling 48 mm
- 11.11.210 Floor anchor M10 x 71 (2 per end coupling)
- 04.24.215 Extended end coupling
- 01.90.360 Mounting clip for knee rail PE125
- 11.11.210 Floor anchor M10 x 71 (2 per mounting clip)
- 01.10.503 Filling ring for application of a 4 cm thick cow mattress

Waved neck bar

With the waved neck bar the shoulder height or diagonal boxside - neck rail can be raised up till 30 cm.

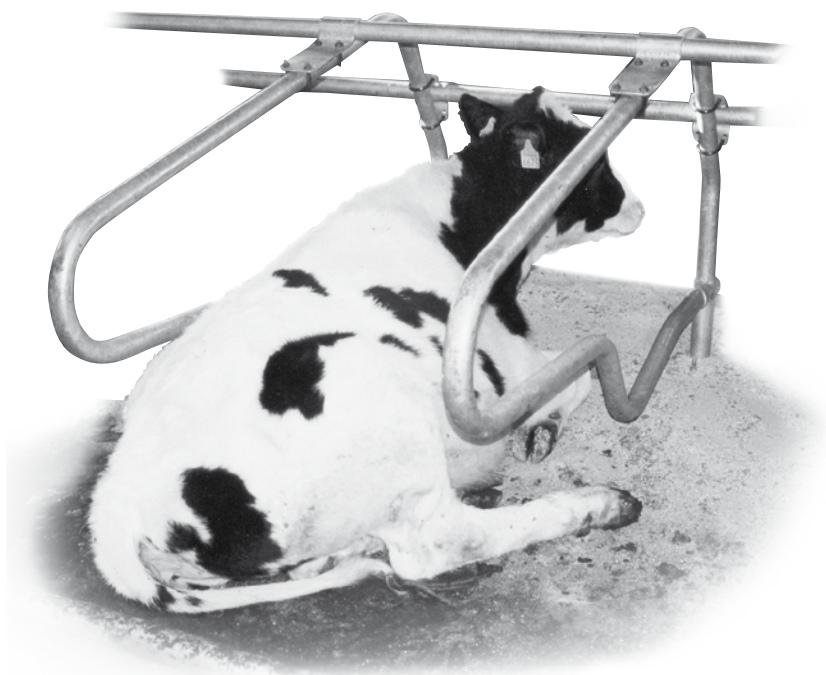

In a modern dairy operation much attention is paid to young stock, and especially to the housing of the young animals. The freestall dividing system is used for all age categories. At a very early age the young animals can get familiar with dry, comfortable and safe stalls, adjusted to their size. A proper, hygienic environment is essential for the development of these animals, and therefore required for an optimal performing dairy cow. With this in mind, Spinder has designed the freestall 'Profit' for every age group. The 'Profit' freestall dividers for young heifers and calves are made of 48 mm tubing, and have all the features and advantages of the dividers for cows and heifers.

01.10.540
Model 'Profit'
for young stock
5-9 months

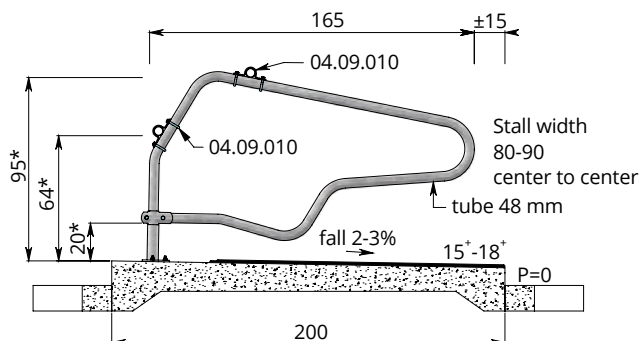

01.10.560
Model 'Profit'
for calves 2-5 months

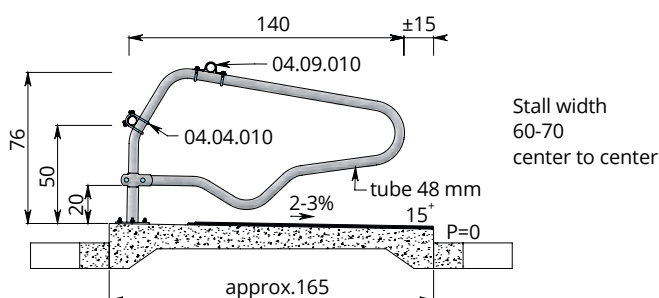

01.10.580
model 'Profit'
for calves ½-2 months

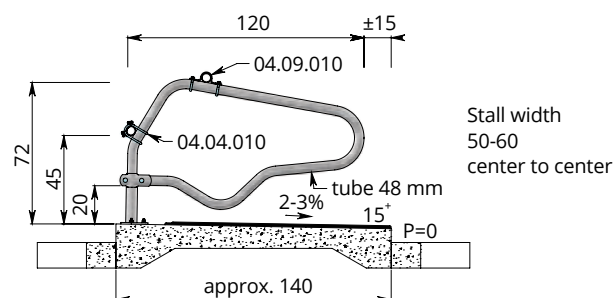

01.10.540 Freestall model 'Profit' 165 for young stock

01.10.560 Freestall model 'Profit' 140 for calves

01.10.580 Freestall model 'Profit' 120 for calves

Mounting support pieces and T-clamps are included with all freestall dividers

Fittings

04.09.010 Strap clamp 48 x 48 mm

04.04.010 Wire clamp 48 x 48 mm

11.11.240 Floor anchor M12 x 106 (3 per divider)

11.12.012 Chemical anchor M12 (10 anchors), an alternative to floor anchor

10.15.600 Tube 48 mm, length 6 m

04.21.015 Tube clamp coupling 48 mm

04.24.015 End coupling 48 mm

11.11.210 Floor anchor M10 x 71 (2 per end coupling)

04.24.115 Adjustable end coupling

04.08.010 Matching cross clamp 48 x 48 mm

01.10.543 Filling ring for application of a 3 cm thick cow mattress

* - measured from the top of the cow mattress

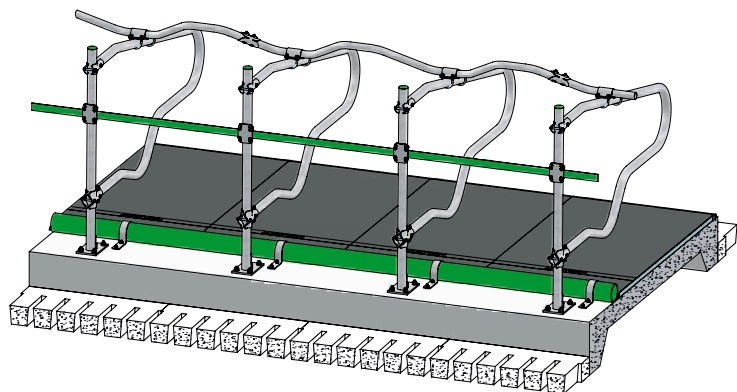

**01.13....
Model 'Comfort-NG'
for cows
mounted to
60 mm support post**

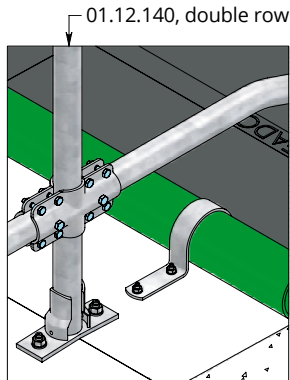
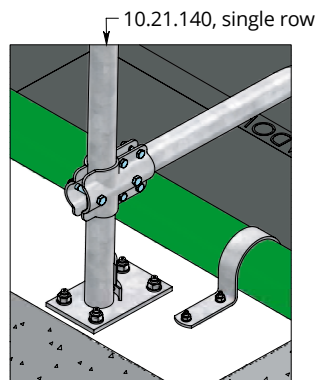
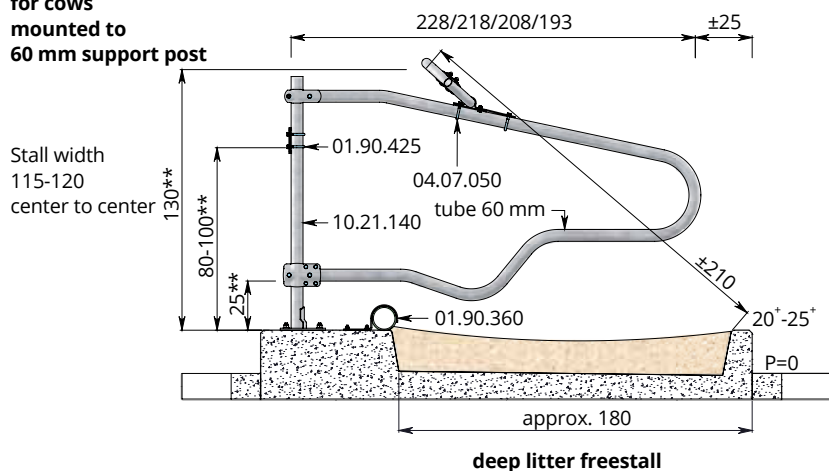

Freestall divider model Comfort-NG

This freestall divider looks a lot like the model Profit. The Spinder curl, the shape of the lower bar, is almost similar. The characteristics of the divider are thus also very similar. Sturdy and robust, positioning the animals in a straight line in the cubicle. At the front the Comfort is more open, leading to even more space to lie down or stand up.

The Comfort cubicle can be mounted on support posts (one post per cubicle) or on horizontal tubing (1 per 2 cubicles). The system Comfort is thus very flexible. When mounted on support posts one can mount 2 cubicles on 1 central post.

- Optimal resting comfort due to careful design;
- Extra space at the front;
- Durability, due to suspended construction;
- Flexible to install;
- All the right dimensions are available;
- Allows for all types of matting materials.

Freestall divider for cows, model 'Comfort-NG', mounted to support post 60 mm (T-clamps or four-way clamps are included)

- 01.13.560** Model 'Comfort-NG' 218 - stall floor ≥ 250 cm
- 01.13.550** Model 'Comfort-NG' 208 - stall floor 240 cm
- 01.13.530** Model 'Comfort-NG' 193 - stall floor 220 cm
- 01.13.575** Model 'Comfort-NG' 228/228 - stall floor 500 cm
- 01.13.565** Model 'Comfort-NG' 218/218 - stall floor 480 cm
- 01.13.555** Model 'Comfort-NG' 208/208 - stall floor 460 cm
- 01.13.545** Model 'Comfort-NG' 193/208 - stall floor 445 cm
- 01.13.535** Model 'Comfort-NG' 193/193 - stall floor 430 cm

Fittings

- 04.07.050** Shoulder rail strap clamp 48 x 60 mm
- 10.21.140** Floor-mounted support post 60 mm x 140 cm (item no. for single row)
- 01.12.140** Floor-mounted support post 60 mm x 140 cm (item no. for double row)
- 10.20.160** Support post 60 mm x 160 cm
- 11.02.200** Plastic protective sleeve 60 mm
- 11.06.200** Stopper 60 mm
- 11.11.250** Floor anchor M16 x 120 mm (use 4 when installing a single row) (use 2 when installing a double row)
- 11.12.016** Chemical anchor M16 (10 anchors)
- 10.15.600** Tube 48 mm, length 6 m
- 04.21.015** Tube clamp coupling 48 mm
- 04.24.215** Extended end coupling
- 01.90.360** Mounting clip for knee rail PE125
- 11.11.210** Floor anchor M10 x 71 (2 per mounting clip)
- 01.90.425** Belt clamp for 60 mm tubing (bolts and nuts are included)
- 01.90.400** Retainer belt 50 mm, 100 m roll
- 01.90.405** Retainer belt 50 mm, 50 m roll

**01.13....
Model 'Comfort-NG'
for cows
Double row
mounted to
60 mm support post**

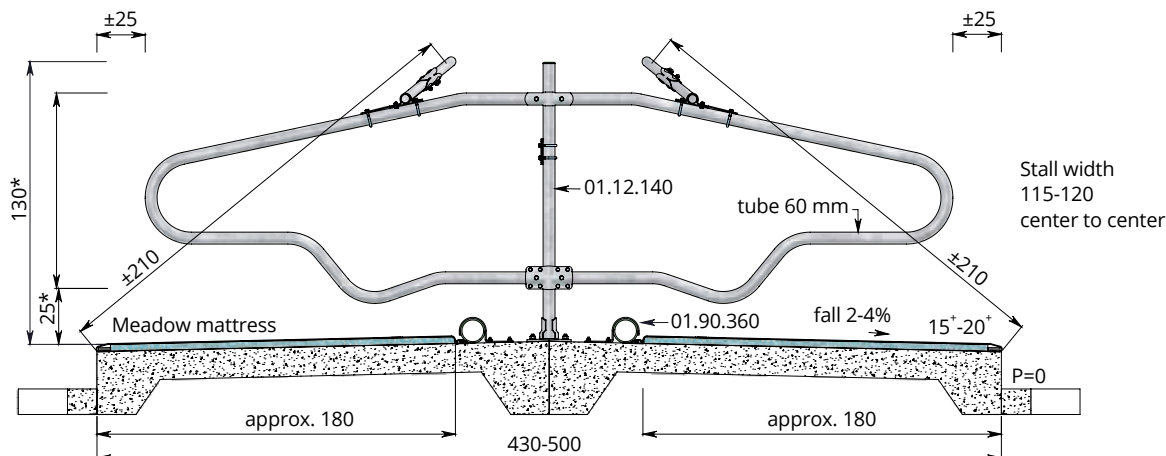

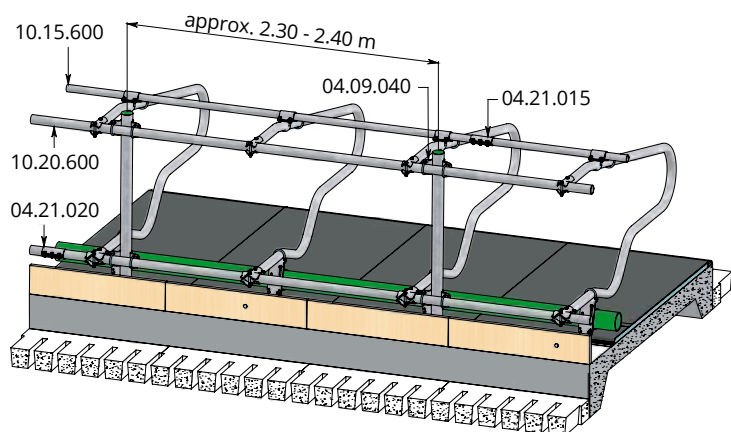

Mounted to horizontal tubing: stall adjustable in height and width.

Freestall divider model 'Comfort-NG', mounted to horizontal tubing

Important advantages:

- Shoulder rail height 120 cm, therefore plenty of room for getting up and laying down;
- Freedom when resting due to the special design;
- Durability, due to the suspended construction;
- Adjustable in height and width;
- Stall is easy to clean;
- Meadow mattress or waterbeds can be placed without any problem;

Freestall divider for cows, model 'Comfort-NG', mounted to horizontal tubing (T-clamps or four-way clamps are included)

01.13.560	Model 'Comfort-NG' 218 - stall floor \geq 250 cm
01.13.550	Model 'Comfort-NG' 208 - stall floor 240 cm
01.13.530	Model 'Comfort-NG' 193 - stall floor 220 cm
01.13.575	Model 'Comfort-NG' 228/228 - stall floor 500 cm
01.13.565	Model 'Comfort-NG' 218/218 - stall floor 480 cm
01.13.555	Model 'Comfort-NG' 208/208 - stall floor 460 cm
01.13.545	Model 'Comfort-NG' 193/208 - stall floor 445 cm
01.13.535	Model 'Comfort-NG' 193/193 - stall floor 430 cm

Fittings

04.07.050	Shoulder rail strap clamp 48 x 60 mm
10.25.160	Support post 76 mm x 160 cm
11.02.250	Plastic protective sleeve 76 mm
11.06.250	Stopper 76 mm
10.26.130	Floor-mounted support post 76 mm x 130 cm
11.11.250	Floor anchor M16 x 120 mm
11.12.016	Chemical anchor M16 (10 anchors) an alternative to floor anchor
04.09.040	Strap clamp 76 x 60 mm
10.15.600	Tube 48 mm, length 6 m
04.21.015	Tube clamp coupling 48 mm
10.20.600	Tube 60 mm, length 6 m
04.21.020	Tube clamp coupling 60 mm
04.24.215	Extended end coupling
04.24.020	End coupling 60 mm
01.90.360	Mounting clip for knee rail PE125
11.11.210	Floor anchor M10 x 71 (2 per mounting clip)

* - measured from the top of the cow mattress

Waved neck bar

With the waved neck bar the shoulder height or diagonal boxside - neck rail can be raised up till 30 cm.

01.13....
Model 'Comfort-NG'
for cows
Double row
mounted to
horizontal tubing

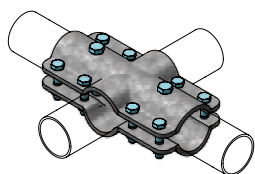

Detail B

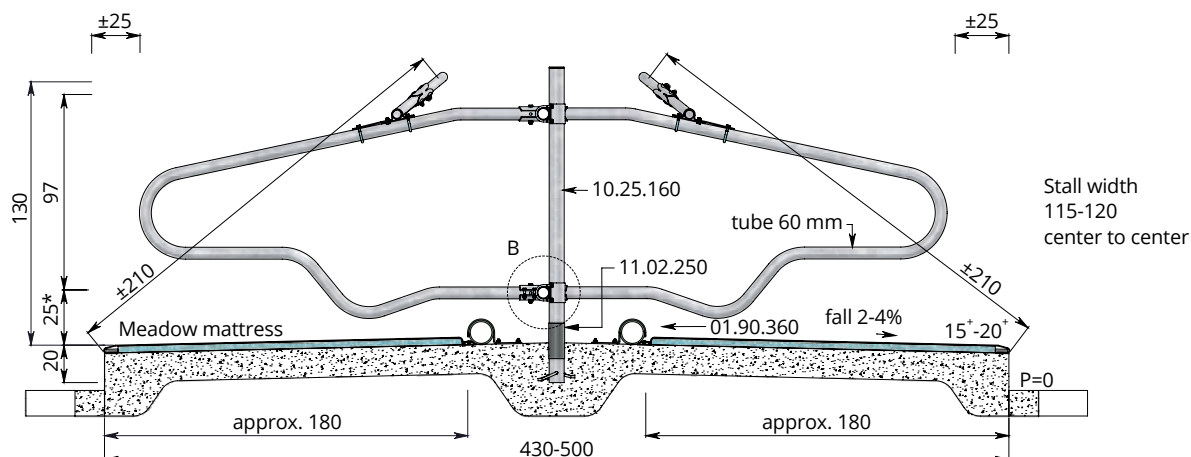

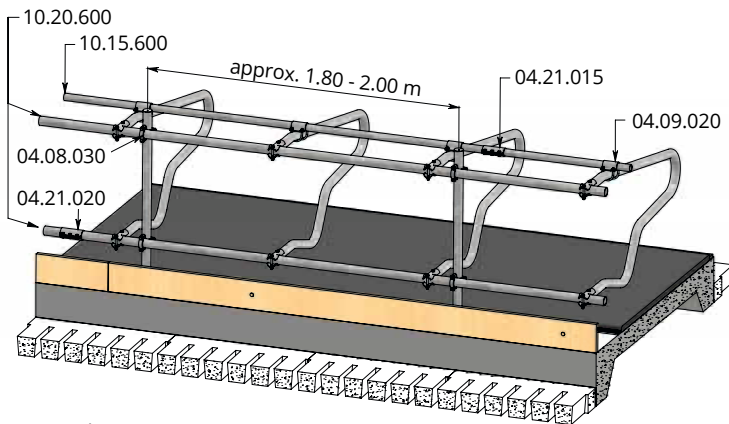

Mounted to 60 mm horizontal tubing; stall adjustable in height and width

01.31.630
Heifers,
10-18 months
Single row

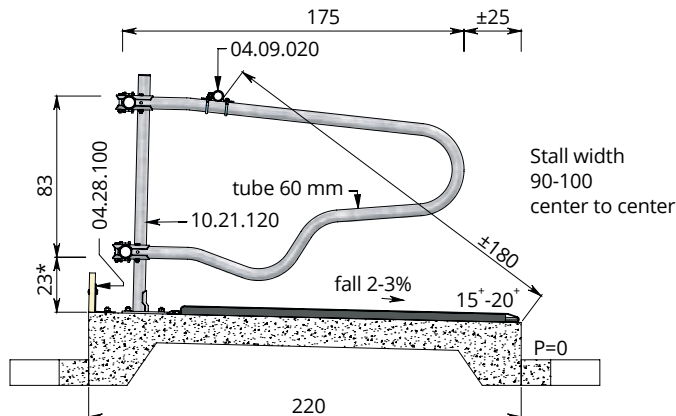

01.31.620
6-10 months
Single row

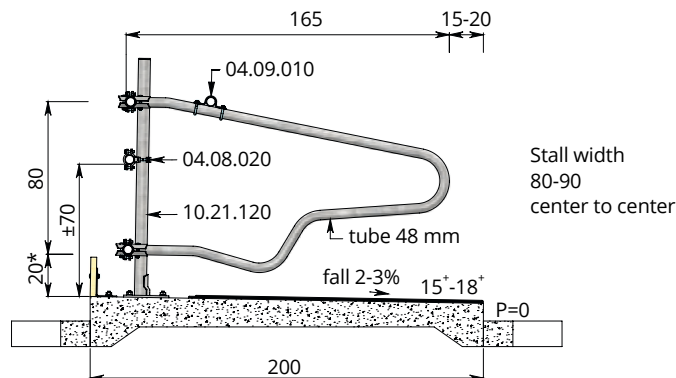

01.31.610
2-6 months
Single row

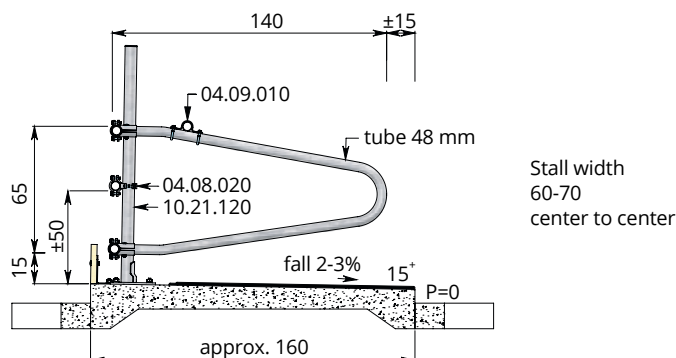

Heifers and young stock are the future of a dairy herd, therefore they need to be well cared for. Dairy farmers working with a freestall system for every age group get better results. Housing of the animals in dry, well-designed stalls with comfortable dividers, is essential for the development of these animals.

<p>01.13.530</p> <p>01.13.535</p>	<p>Heifers 18-22 months, stall width 100-110 center to center</p> <p>Single row 60 mm, (T-clamps included) Model 'Comfort-NG' 193</p> <p>Double row 60 mm, (four-way clamps included) Model 'Comfort-NG' 193/193</p> <p>Fittings See page 1.5</p>
<p>01.31.630</p> <p>01.31.635</p> <p>04.09.020</p> <p>11.06.200</p> <p>10.21.120</p> <p>11.11.250</p> <p>11.12.016</p> <p>04.08.030</p> <p>10.15.600</p> <p>04.21.015</p> <p>10.20.600</p> <p>04.21.020</p> <p>04.24.115</p> <p>04.08.010</p> <p>04.24.020</p> <p>04.28.100</p>	<p>Heifers 10-18 months, stall width 90-100 center to center</p> <p>Single row 60 mm, (T-clamps included) Double row 60 mm, (four-way clamps included)</p> <p>Fittings</p> <p>Strap clamp 48 x 60 mm</p> <p>Stopper 60 mm</p> <p>Floor-mounted support post 60 mm x 120 cm</p> <p>Floor anchor M16 x 120 mm</p> <p>Chemical anchor M16 (10 anchors) an alternative to floor anchor</p> <p>Cross clamp 60 x 60 mm</p> <p>Tube 48 mm, length 6 m</p> <p>Tube clamp coupling 48 mm</p> <p>Tube 60 mm, length 6 m</p> <p>Tube clamp coupling 60 mm</p> <p>Adjustable end coupling</p> <p>Matching cross clamp 48 x 48 mm</p> <p>End coupling 60 mm</p> <p>Angle support 10 x 14 cm</p>
<p>01.31.620</p> <p>01.31.625</p>	<p>Calves 6-10 months</p> <p>Single row 48 mm, (T-clamps included) Double row 48 mm, (four-way clamps included)</p>
<p>01.31.610</p> <p>04.09.010</p> <p>11.06.200</p> <p>10.21.120</p> <p>11.11.250</p> <p>11.12.016</p> <p>04.08.020</p> <p>10.15.600</p> <p>04.21.015</p> <p>04.24.115</p> <p>04.08.010</p> <p>04.24.015</p> <p>04.28.100</p>	<p>Calves 2-6 months</p> <p>Single row 48 mm, (T-clamps included)</p> <p>Fittings</p> <p>Strap clamp 48 x 48 mm</p> <p>Stopper 60 mm</p> <p>Floor-mounted support post 60 mm x 120 cm</p> <p>Floor anchor M16 x 120 mm</p> <p>Chemical anchor M16 (10 anchors) an alternative to floor anchor</p> <p>Cross clamp 48 x 60 mm</p> <p>Tube 48 mm, length 6 m</p> <p>Tube clamp coupling 48 mm</p> <p>Adjustable end coupling</p> <p>Matching cross clamp 48 x 48 mm</p> <p>End coupling 48 mm</p> <p>Angle support 10 x 14 cm</p> <p>* - measured from the top of the cow mattress</p>



The Spinder 'Cosmos' free stall divider is a prime example of an 'open' cubicle. Large and spacious: therefore very animal friendly. This open system provides room enough for the cow to move naturally, when getting up and laying down. Consequentially the cows will lay down sooner which will improve production and hoof health.

For matting we advise a cow mattress: the Spinder Meadow mattress or the waterbeds. The combination Cosmos and loose bedding is also a possibility.

The PE retaining knee rail ensures for a perfect position of the animal, resulting in clean cows and cubicles.

Major characteristics:

- Exceptionally 'open' cubicle which allows the cow to move naturally, when getting up and laying down;
- Plenty head space;
- Simple and solid design;
- Neck rail: 120 cm;
- Widely applicable;
- Easy to install and adjust;
- Flexible and adjustable knee rail;

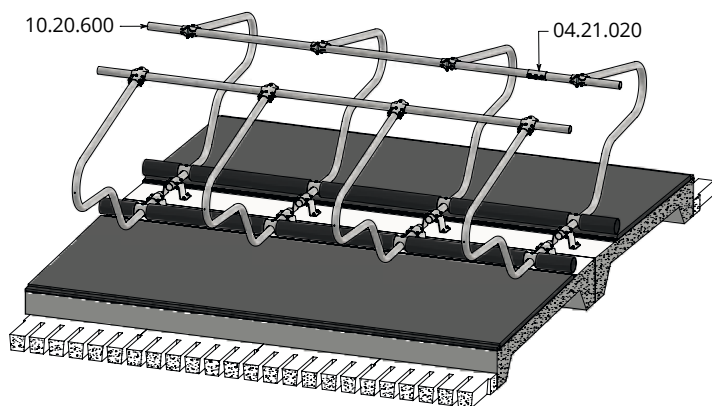

01.15.500 Freestall divider model 'Cosmos' (mounting support piece and T-clamp included)

Fittings

- 11.11.240** Floor anchor M12 x 106 (4 per divider)
10.20.600 Tube 60 mm, length 6 m
04.21.020 Tube clamp coupling 60mm
04.24.020 End coupling 60 mm
11.06.200 Stopper 60 mm
01.15.550 Knee rail attachment PE125 for 'Cosmos', adjustable (1 per divider)
01.15.560 PE125 knee rail, length 1.00 Mtr. (stall width 110-115 cm)
01.15.561 PE125 knee rail, length 1.07 Mtr. (stall width from 115 cm)
01.15.565 PE125 knee rail, length 1.25 Mtr. (last knee rail, from divider to end wall)
01.90.370 End coupling for knee rail PE125 (attachment knee rail at end wall)
11.11.210 Floor anchor M10 x 71 mm (2 per end coupling)
01.15.590 Quick release for Cosmos

Model 'Cosmos' with head rail and neck rail

01.15.525 Connection for head rail four-way clamp incl. (1 per divider)

01.15.500
Model 'Cosmos'
for cows

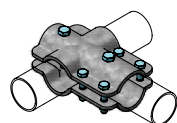

Detail A

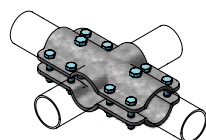

Detail B

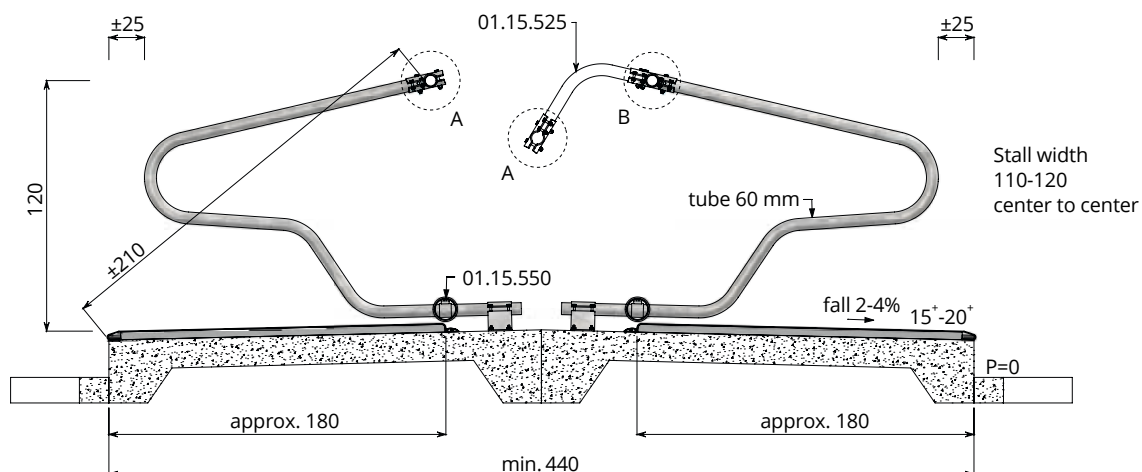



01.15.500
Model 'Cosmos'
for cows,
single row at
outer wall

Stall width
110-120
center to center

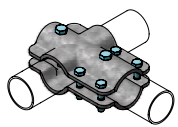

Detail A

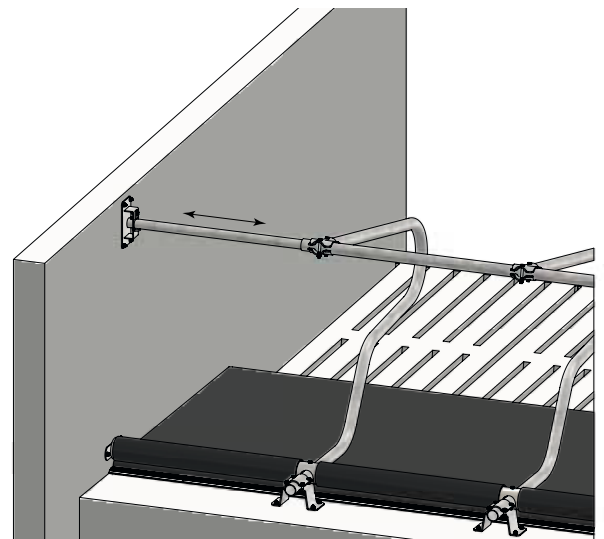
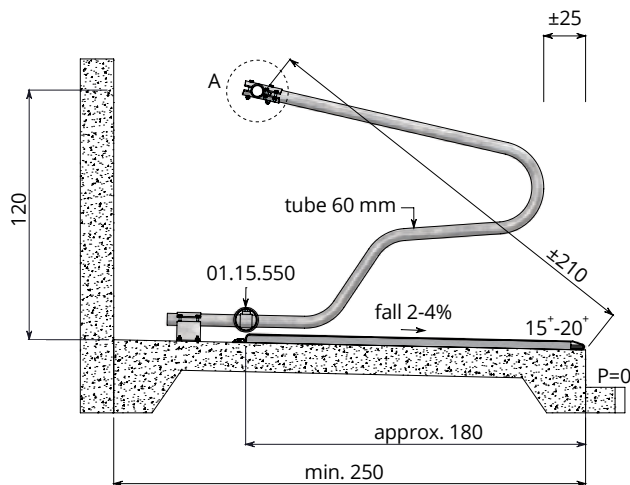

- Quick release for easy backdriving cow

01.15.500
Model 'Cosmos'
for cows,
single row,
unattached

Stall width
110-120
center to center

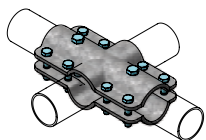

Detail B

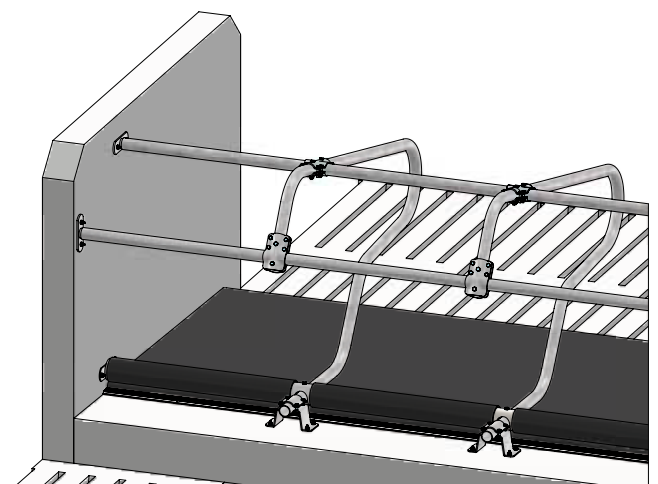
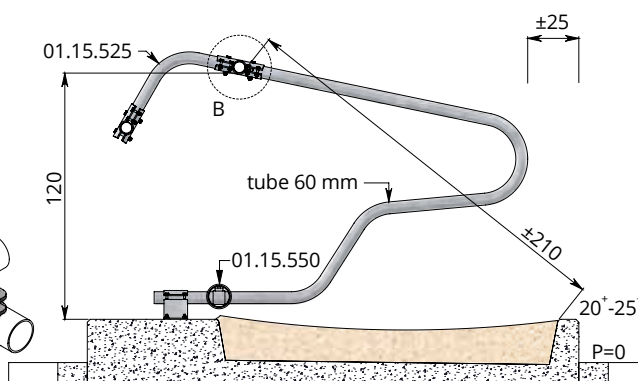



01.10.513 / 01.10.510 / 01.10.500
Model 'Profit' 216 / 206 / 190
for cows

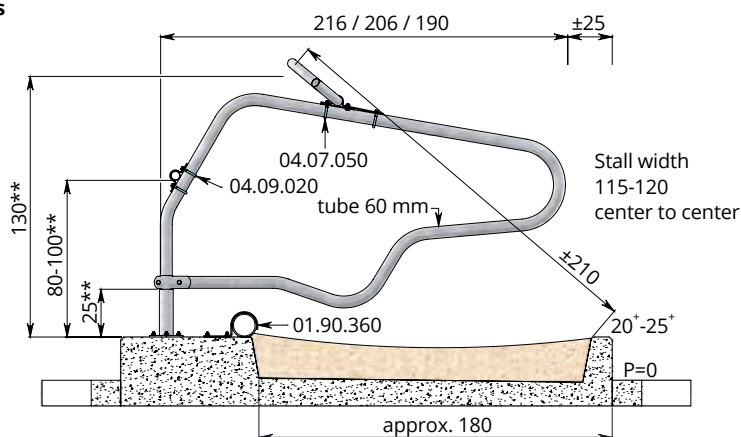

01.13....
Model 'Comfort-NG'
for cows
mounted to
60 mm support post

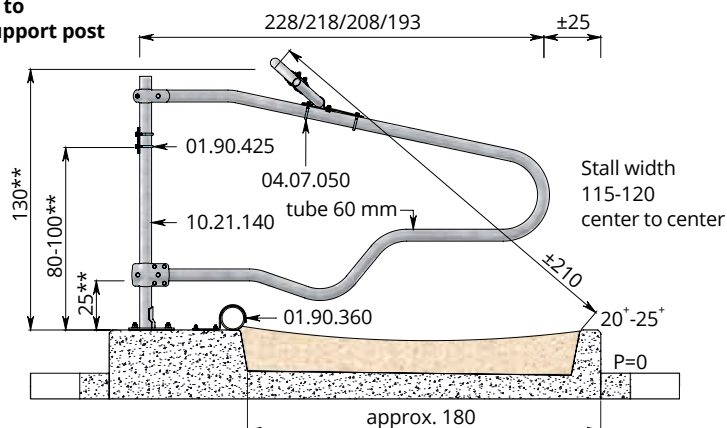

Special model for deep bedding freestalls

Cow comfort is a hot topic in modern dairy farming. As well as units with cow mattresses and waterbeds, many stalls are fitted with deep-bedded floors. The type of stuffing depends on the availability of materials or the dairy farmer's preference. For optimal deep bedding, a 15-20 cm matting is recommended. The realisation of this thickness requires a rounded 20-25 cm high rear edge in relation to the dung floor. Boundaries of similar height are required for the cubicle; the knee bar is mounted above the edge.

Waved neck bar

With the waved neck bar the shoulder height or diagonal boxside - neck rail can be raised up till 30 cm.

'Profit' for deep litter freestalls

Freestall divider model 'Profit' for cows and heifers (mounting support piece and T-clamp included)

- 01.10.513** Freestall divider model 'Profit' 216 for cows
- 01.10.510** Freestall divider model 'Profit' 206 for cows
- 01.10.500** Freestall divider model 'Profit' 190 for cows
- 01.10.520** Freestall divider model 'Profit' 175 for heifers

Fittings

- 04.07.050** Shoulder rail strap clamp 48 x 60 mm
- 04.09.020** Strap clamp 48 x 60 mm
- 11.11.240** Floor anchor M12 x 106 (3 per divider)
- 11.12.012** Chemical anchor M12 (10 anchors), an alternative to floor anchor
- 10.15.600** Tube 48 mm, length 6 m
- 04.21.015** Tube clamp coupling 48 mm
- 04.24.015** End coupling 48 mm
- 11.11.210** Floor anchor M10 x 71 (2 per end coupling)
- 04.24.215** Extended end coupling
- 01.90.360** Mounting clip for knee rail PE125
- 11.11.210** Floor anchor M10 x 71 (2 per mounting clip)

'Comfort' for deep litter freestalls

Freestall divider for cows, model 'Comfort-NG', mounted to support post 60 mm (T-clamps or four-way clamps are included)

- 01.13.560** Model 'Comfort-NG' 218 - stall floor \geq 250 cm
- 01.13.550** Model 'Comfort-NG' 208 - stall floor 240 cm
- 01.13.530** Model 'Comfort-NG' 193 - stall floor 220 cm
- 01.13.575** Model 'Comfort-NG' 228/228 - stall floor 500 cm
- 01.13.565** Model 'Comfort-NG' 218/218 - stall floor 480 cm
- 01.13.555** Model 'Comfort-NG' 208/208 - stall floor 460 cm
- 01.13.545** Model 'Comfort-NG' 193/208 - stall floor 445 cm
- 01.13.535** Model 'Comfort-NG' 193/193 - stall floor 430 cm

Fittings

- 04.07.050** Shoulder rail strap clamp 48 x 60 mm
- 10.21.140** Floor-mounted support post 60 mm x 140 cm (item no. for single row)
- 01.12.140** Floor-mounted support post 60 mm x 140 cm (item no. for double row)
- 10.20.160** Support post 60 mm x 160 cm
- 11.02.200** Plastic protective sleeve 60 mm
- 11.06.200** Stopper 60 mm
- 11.11.250** Floor anchor M16 x 120 mm (use 4 when installing a single row) (use 2 when installing a double row)
- 11.12.016** Chemical anchor M16 (10 anchors)
- 01.90.360** Mounting clip for knee rail PE125
- 11.11.210** Floor anchor M10 x 71 (2 per mounting clip)
- 01.90.425** Belt clamp for 60 mm tubing (bolts and nuts are included)
- 01.90.400** Retainer belt 50 mm, 100 m roll
- 01.90.405** Retainer belt 50 mm, 50 m roll

** - measured from the top of the litter bed



Waved neck rail

The wave of the neck rail guides the animal to the centre of the cubicle, where she will stand up and lie down. This will make the animal lie straighter with less manure left in the stall. Flexible assembly results in the ideal dimensions.

Many cubicles are too small (too narrow, too short, too low) for today's large cows. The waved neck rail makes better use of the space in the front of the stall. The wither height of the stall can be increased by as much as 30 centimetres.

Through its shape, the attachment point of the waved neck rail lies further to the back; that makes the overall cubicle construction more stable and stronger.

Important features:

- The waved neck rail allows the variable adjustment in a diagonal manner;
- Move the neck rail clamp back -> more stability;
- Can be universally used for any type of freestall divider;
- Steering effect, the cow is forced to stand straight up in the stall;
- Available for stall widths of 110, 112.5, 115, 120, 125 and 131 cm;
- The combination of waved neck bars of different dimensions (alternating assembly) allows the filling of the stall widths in between. E.g. assembly of alternating 2 x 115 and 2 x 120 for a row with a stall width of 117.5 cm;
- Linked per 2 stalls.

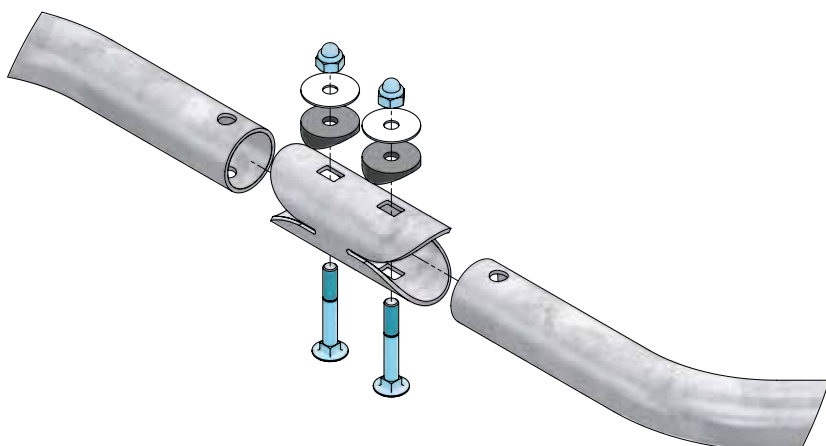

01.92.110	Waved neck bar 2 x 110 cm
01.92.112	Waved neck bar 2 x 112,5 cm
01.92.115	Waved neck bar 2 x 115 cm
01.92.120	Waved neck bar 2 x 120 cm
01.92.125	Waved neck bar 2 x 125 cm
01.92.131	Waved neck bar 2 x 131 cm

01.92.150 Starting wave neck bar - 50 cm

Fittings wall fastening

01.91.157	End coupling extended for waved neck bar
11.11.210	Floor anchor M10 x 71 mm (2 per end coupling)

* - measured from the top of the cow mattress

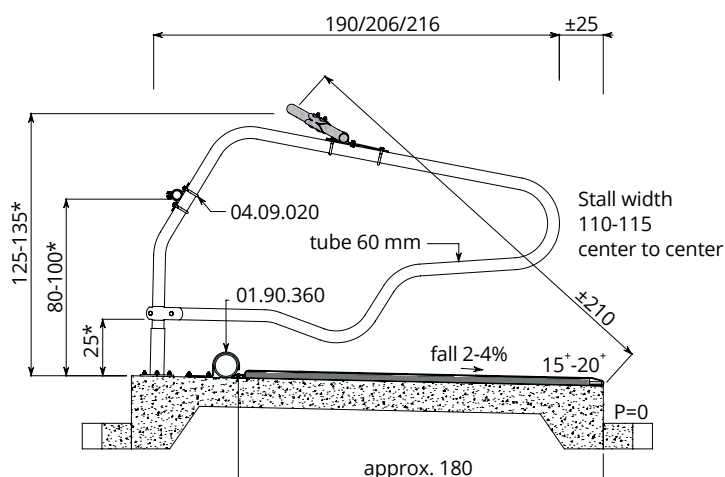
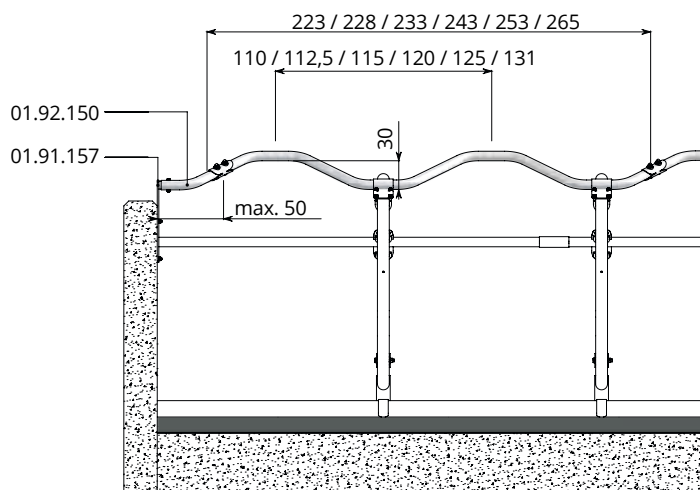



PE retaining knee rail

An ideal solution, to prevent the cows from going too far to the front in the stall, is to install a polyethelene (PE) knee rail. The PE knee rail guides the animal into the perfect position when laying down. As a result the animals will stand up with more ease and the stalls will stay much cleaner. The cows can stretch their front legs comfortably over the rail. The characteristic of polyethelene that it will stay flexible, prevents the knee rail from breaking.

The knee rail can be mounted directly to the concrete floor with a special mounting clip.

Important characteristics:

- PE stays flexible, therefore very durable;
- Robust, material thickness 7,3/9,5 mm;
- Round shape; does not pinch in the legs;
- Can be used with all kinds of bedding materials;

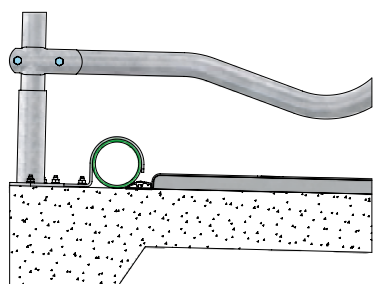
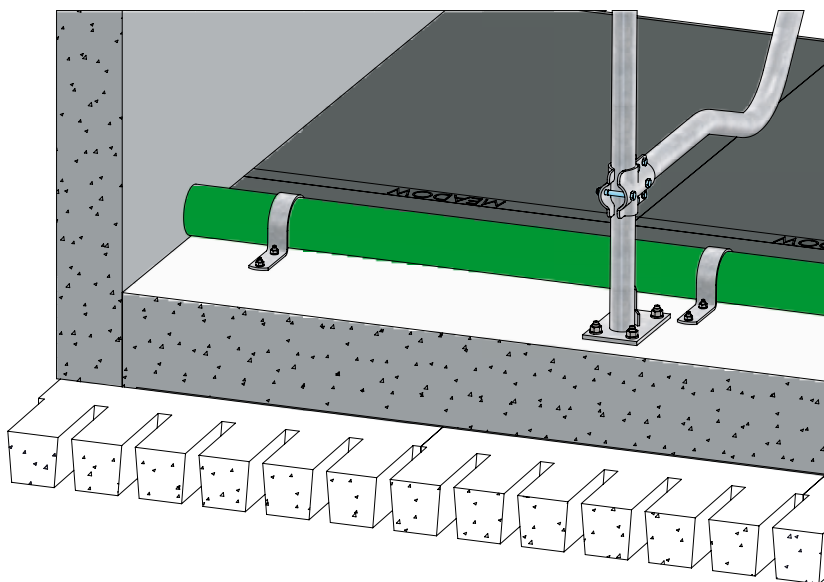

- Mounting clip for knee rail PE125, 160

PE125 knee rail, material thickness 7,3 mm

- | | |
|-----------|---|
| 01.90.351 | PE125 knee rail - green, length 6 m |
| 01.90.364 | Coupling for PE125 knee rail |
| 01.90.360 | Mounting clip for knee rail PE125 |
| 11.11.210 | Floor anchor M10 x 71 (2 pc. per mounting clip) |

PE160 knee rail, material thickness 9,5 mm

- | | |
|-----------|---|
| 01.90.356 | PE160 knee rail - green, length 6 m |
| 01.90.365 | Connection sleeve for PE160 knee rail |
| 01.90.362 | Mounting clip for knee rail PE160 |
| 11.11.210 | Floor anchor M10 x 71 (2 pc. per mounting clip) |

Meadow Next mattress

The Meadow Next mattress is soft and extremely resilient. For this reason the cows will lie down comfortably for a long period of time, and the surface of the mattress will keep its even shape. The main part of the day cows are lying down to ruminate. While in the barn, dairy cows prefer a stall with a soft bedding. This results in longer hours of resting and therefore the cows will be in a good condition to produce more milk.

Soft and resilient

The Meadow mattress is composed out of a high quality latex foam, surrounded with PVC wrap and a rubber top mat. The total thickness of the mattress is 4 cm (for heifers 3,3 cm).

Durable top mat on a roll

The 4 mm thick top mat (for heifers 3,2 mm) is made of rubber with a carcass of a strong ply of polyester-nylon. The mat is attached to the floor on all sides. This to prevent moisture and manure from creeping underneath the top mat, which is essential for the hygiene and durability of the latex foam layer. Moreover the top mat is exceedingly durable.

Secure grip for lying down and getting up

The non-skid top surface of the Meadow Next mattress provides the cows with sufficient grip for laying down and getting up.

Protection at the rear

The rear of the stall endures the most wear by way of cow traffic. The top mat is fastened at the rear with a solid rubber/plastic strip 60 mm wide. This also gives the advantage that the mattress slopes down, so moisture will drain and the mattress is easy to clean.

Easy to mount

Mounting is simple. At the rear the mattress is attached to the floor with a flexible rubber strip and at the front and sides with aluminium or PVC mounting profiles. Special nails are used for secure mounting. After drilling a hole the nails can be hammered in the concrete without using a plug.

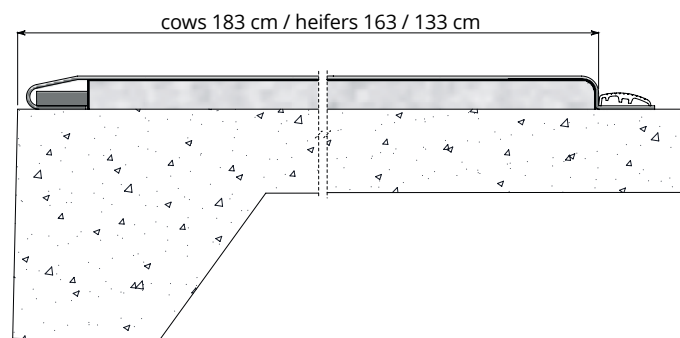

Longevity

The Meadow Next mattress is very durable, whilst retaining its comfort. With a warranty of 10 years on the top mat it is a solid investment (ask for warranty details).

Available for cows and heifers

The Meadow Next mattress is available in sizes for cows and heifers.

Cows

Thickness: 4 cm
Width: 185 cm
Top mat: rubber with nylon carcass 4 mm, width 200 cm
Mounting: Rubber strip 20 x 60 mm and aluminum profiles

Heifers

Thickness: 3,3 cm
Width: 165 / 135 cm
Top mat: rubber with nylon carcass 3,2 mm, width 180 cm
Mounting: plastic strip 15 x 60 mm and aluminum profiles



Meadow Next mattress for cows	
05.06.100	Meadow mattress 185 cm, per meter Mounting materials included
05.10.830	Aluminum mounting profile 180 cm - nails included
05.07.500	Additional charge ordering less than 10 m
Meadow Next mattress for heifers	
05.06.165	Meadow mattress 165 cm, per meter Mounting materials included
05.10.832	Aluminum mounting profile 160 cm - nails included
05.06.135	Meadow mattress 135 cm, per meter Mounting materials included
05.10.834	Aluminum mounting profile 130 cm - nails included
05.07.500	Additional charge ordering less than 10 m

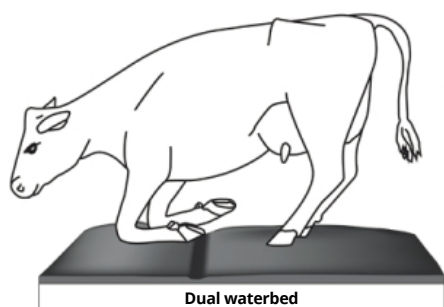
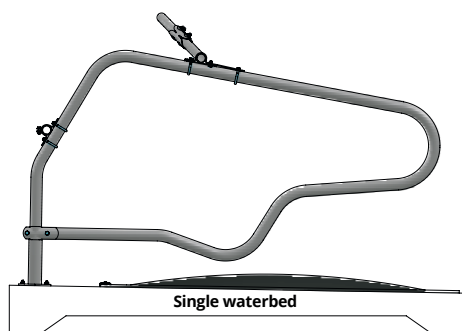

Waterbeds

Waterbeds provide optimal lying comfort. When the animals lie down, they are floating on a layer of water to avoid any pressure points; this will result in fewer joint problems and better animal welfare. With the cows standing on the waterbed, their legs will push the water directly underneath aside for a stable position.

A waterbed also has an insulating effect; the water is cooler than the environment in summer, and warmer than the environment in winter. Very pleasant for the animals. On top of that there is a strong relationship between the temperature of the lying area and milk leakage. Cooler means less milk leakage.

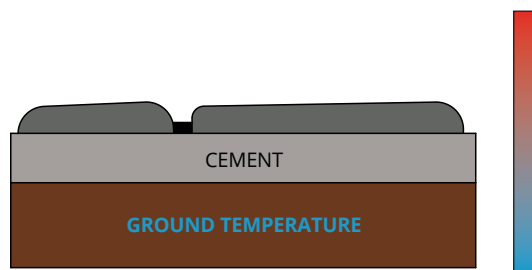

Waterbeds will regain their original shape after the animal has moved away; a convex shape. This helps to discharge any moisture from the waterbed and allows for faster drying. Dry and hygienic. A waterbed will therefore require a small amount of litter and, perhaps more importantly, is saving labour for the dairy farmer.

A waterbed consists of two thick layers of rubber that are vulcanised to one another at the edges. Plastic reinforcement is inside the rubber. As a result, the rubber layers are very strong and last a long time. And water? That remains water. In short, a waterbed lasts for many years without compromising the comfort.

Cost-wise, it can be said that waterbeds constitute a substantial capital expenditure, even more so if compared to deep litter, but in terms of annual expenditure the waterbeds are among the most economical solutions (depreciation over more than 10 years, less labour, less litter, good hygiene).

In short: a waterbed for optimum cow comfort and better returns.

Waterbeds come in a number of widths to suit the various stall widths. The water compartments are sealed with a special shut-off valve.

There are two kinds of waterbeds:

- **Single waterbeds**, in which the water compartment is one unit;
- **Dual waterbeds**, separating the front (knee) from the rear (belly/hock) water compartment. This gives the Dual waterbeds extra knee comfort.

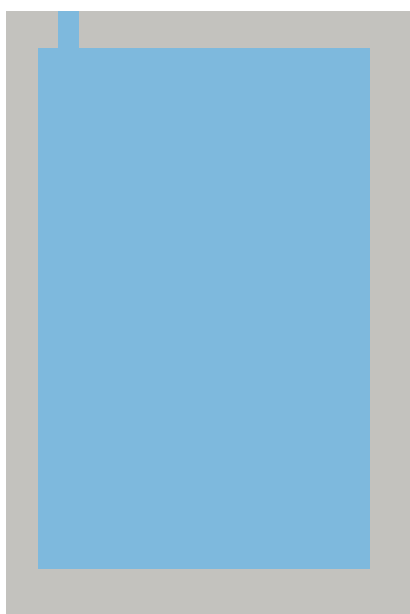

Single Waterbed

The single waterbed consists of one water compartment; so it makes up one large cubicle bed.

Single waterbed, important features:

- Available for various stall widths;
- The standard length is 183 cm;
- 1 filling point, at the front;
- The PE knee bar allows you to set the stall length to suit the herd;
- 10-year reducing guarantee.

Single Waterbed

Delivered on customer defined length per cubicle row, including:

- 2 stainless steel side profiles for waterbed 183 per defined length
- total amount of aluminum top-strips
- total amount of stainless steel nails
- total amount of stainless steel closures.

Freestall width:

05.02.110	110 cm
05.02.112	112,5 cm
05.02.115	115 cm
05.02.120	120 cm

Needed per project:

05.10.880	Socket punch (1 per delivery)
05.10.855	Filling kit, with nozzle, water meter and ball valve

Optional (when needed additionally)

05.10.910	Stainless steel side profile for waterbed 183 cm
-----------	--

PE125 knee rail - material thickness 7.3 mm

01.90.351	PE125 knee rail - green, length 6 m
01.90.364	Coupling for PE125 knee rail
01.90.375	Cover for PE 125
01.90.360	Mounting clip for knee rail PE125 (1 mounting clip per 1.10 - 1.25 m)
11.11.210	Floor anchor M10 x 71 (2 per mounting clip)



Dual waterbed

In Dual waterbeds is a separation between the front (knee) and the rear (belly/hock) water compartment. The knee compartment is filled with water in such a way that a cushion of water is always present under the cow's knees when she is lying down. The details of comfort!

Dual waterbed, important features:

- Available for various stall widths;
- The standard length is 183 cm;
- 2 filling points, 1 on the front and 1 on the back;
- The PE knee bar allows you to set the stall length to suit the herd;
- 10-year reducing guarantee.



Dual waterbed

Delivered on customer defined length per cubicle row, including:

- 2 stainless steel side profiles for waterbed 183 per defined length
- total amount of aluminum top-strips
- total amount of stainless steel nails
- total amount of stainless steel closures.

Freestall width:

05.03.110	110 cm
05.03.112	112,5 cm (44")
05.03.115	115 cm
05.03.117	46" (117 cm)
05.03.120	120 cm
05.03.122	48" (122 cm)
05.03.125	125 cm

Junior: for Bed sizes:

05.03.086	86,3 x 160 cm (6 - 10 months)
05.03.096	96,5 x 183 cm (10 - 18 months)
05.03.107	107 x 183 cm (18 - 22 months)

Needed per project:

05.10.880	Socket punch (1 per delivery)
05.10.855	Filling kit, with nozzle, water meter and ball valve

Optional (when needed additionally)

05.10.910	Stainless steel side profile for waterbed 183 cm
05.10.905	Stainless steel side profile for waterbed 160 cm

PE125 knee rail - material thickness 7.3 mm

01.90.351	PE125 knee rail - green, length 6 m
01.90.364	Coupling for PE125 knee rail
01.90.375	Cover for PE 125
01.90.360	Mounting clip for knee rail PE125 (1 mounting clip per 1.10 - 1.25 m)
11.11.210	Floor anchor M10 x 71 (2 per mounting clip)

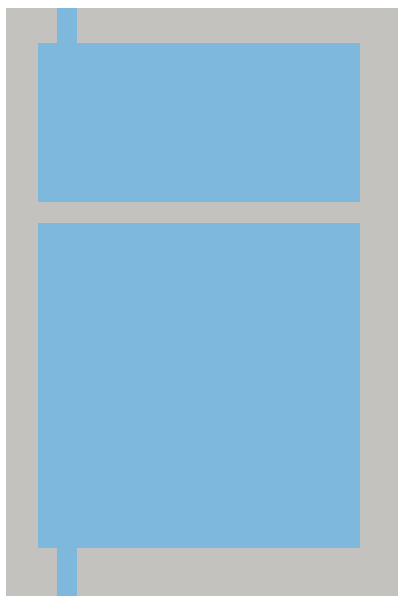



• Studded rubber mat



• Studded rubber mat



• Galvanized fastening profiles are installed with concrete screws

Studded rubber mat

The studded mats are made of flexible rubber with a closed structure; this structure makes it hard for dirt to cake to the mat and makes cleaning easy. The fabric reinforcement provides a stable and solid mat. The studs underneath the mat have a spring-type effect for better lying comfort. The mats are available by the roll or cut to size. Easy to assemble and suitable for almost any freestall dividers.

Important features

- Durable;
- Permanently flexible;
- Non-slip;
- Thickness 18 mm;
- Width: 180 and 160 cm;
- Available by the roll (60 m) or cut to size.

Studded rubber mat: width 180 cm	
05.20.181	Full coil, length 60 m
05.20.280	Cut to desired length (max. 60 m), per meter
Fittings	
05.10.705	Fastening profile for top side 200 cm, screws included
05.10.710	Fastening profile for the sides, length 175 cm, for studded rubber mat 180 cm, screws included

Studded rubber mat: width 160 cm	
05.20.161	Full coil, length 60 m
05.20.260	Cut to desired length (max. 60 m), per meter
Fittings	
05.10.705	Fastening profile for top side 200 cm, screws included
05.10.720	Fastening profile for the sides, length 150 cm, for studded rubber mat 160 cm, screws included

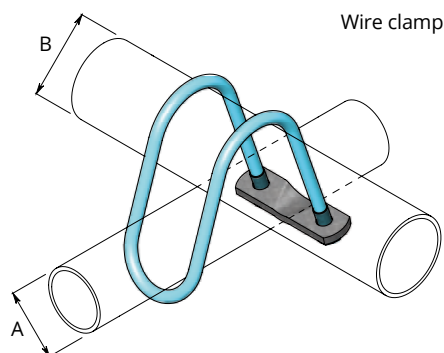

Wire clamp

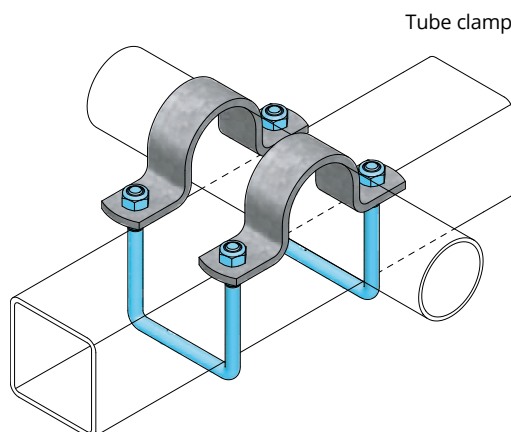

Tube clamp

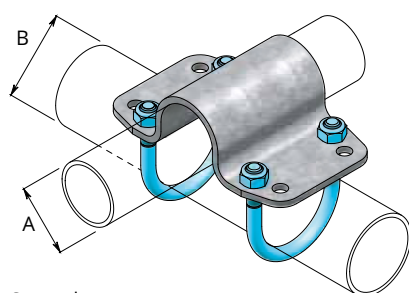

Strap clamp

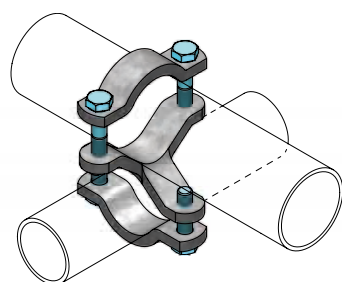

Cross clamp

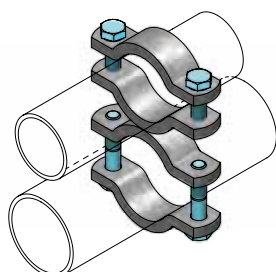

Three-part parallel clamp

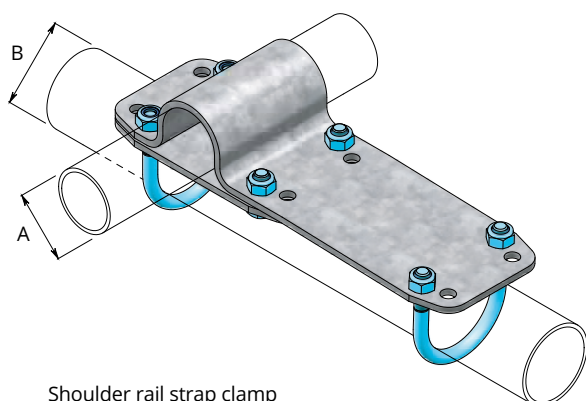

Shoulder rail strap clamp

04.04.005 04.04.010 04.04.015 04.04.020	Wire clamp
	Size A x B 34 x 34 mm (TG245) 48 x 48 mm 48 x 60 mm 76 x 48 mm
04.22.065 04.22.080 04.22.085	Tube clamp
	For clamping square and round tubing.
	Size 70 ... 80 x 60 mm 60 x 102 mm 60 x 114 mm
04.09.010 04.09.020 04.09.025 04.09.030 04.09.040 04.09.050 04.09.060	Strap clamp
	Recommended for mounting shoulder rails to freestalls.
	Size A x B 48 x 48 mm 48 x 60 mm 60 x 60 mm 76 x 48 mm 76 x 60 mm 89 x 48 mm 89 x 60 mm
04.16.010 04.16.020 04.16.030	Three-part parallel clamp
	Size 48 x 48 mm 48 x 60 mm 60 x 60 mm
04.08.010 04.08.020 04.08.030	Cross clamp
	Size 48 x 48 mm 48 x 60 mm 60 x 60 mm
04.07.049 04.07.050	Shoulder rail strap clamp
	Specifically made for mounting the shoulder rail to suspended freestalls:
	Size A x B 48 x 48 mm 48 x 60 mm

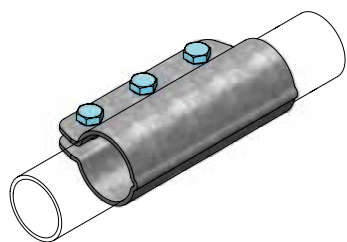

Tube clamp coupling

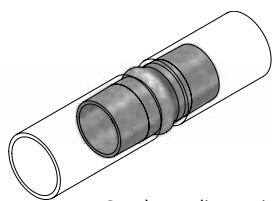

Steel coupling unit

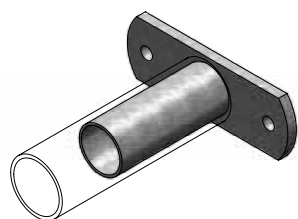

End coupling

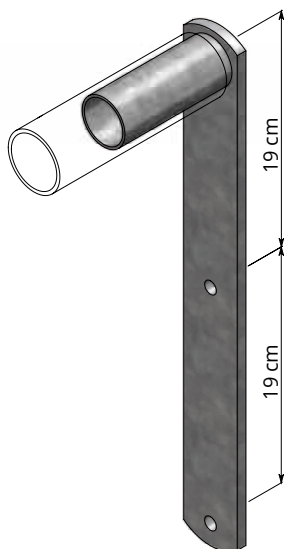

Extended end coupling

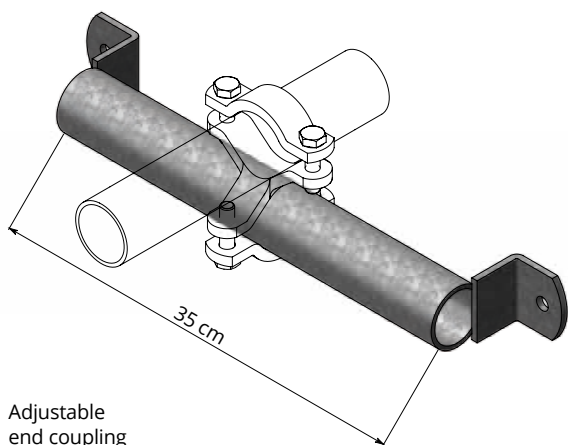

Adjustable end coupling

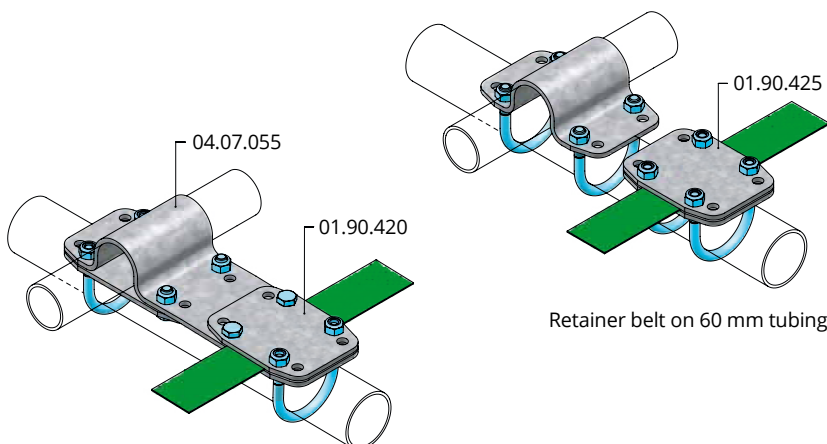

Retainer belt on shoulder rail strap clamp

<p>04.21.015 04.21.020</p>	<p>Tube clamp coupling</p> <p>Specially designed tube clamp coupling for extra sturdiness, e.g. for mounting shoulder rails to suspended freestalls.</p> <p>Size For tube 48 mm For tube 60 mm</p>
<p>04.20.015 04.20.020 04.20.025</p>	<p>Steel coupling unit</p> <p>Steel coupling unit to connect tubing.</p> <p>Size For tube 48 mm For tube 60 mm For tube 76 mm</p>
<p>04.24.015 04.24.020</p>	<p>End coupling</p> <p>For mounting tubing to the wall or the floor, e.g. for mounting neck rail to a wall.</p> <p>Size For tube 48 mm For tube 60 mm</p>
<p>04.24.115 04.08.010 04.04.010</p>	<p>End coupling, adjustable</p> <p>For adjustable mounting of the shoulder rail to the wall by means of a wire clamp or cross clamp.</p> <p>Size 48 mm x 35 cm</p> <p>Fittings Cross clamp 48 x 48 mm Wire clamp 48 x 48 mm</p>
<p>04.24.215</p>	<p>Extended end coupling</p> <p>For mounting a shoulder rail to an end wall which is positioned lower.</p>
<p>01.90.400 01.90.405 01.90.420 04.07.055 01.90.425</p>	<p>Retainer belt for freestall dividers</p> <p>A nylon retainer belt instead of a shoulder rail to position the animal. It prevents the cow from rough contact with the shoulder rail. The retainer belt is mounted to each freestall divider with clamps special designed for this product.</p> <p>Retainer belt 50 mm, 100 m roll Retainer belt 50 mm, 50 m roll Belt clamp for mounting on plate clamp (bolts and nuts are included) Shoulder rail strap clamp with additional holes for mounting the retainer belt Belt clamp for 60 mm tubing (threaded straps and nuts are included)</p>

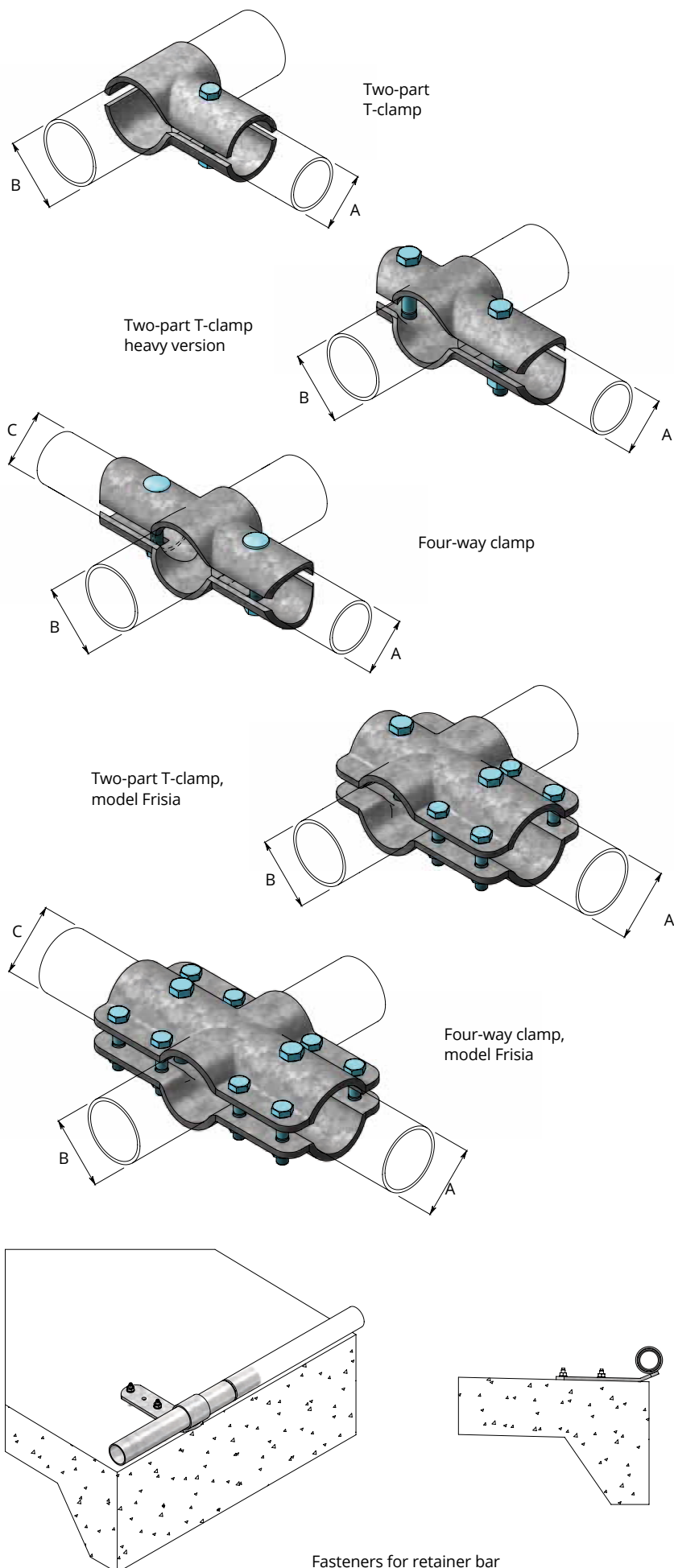

04.12.010 04.12.020 04.12.130 04.12.040 04.12.160 04.12.190	Two-part T-clamp Size A x B 34 x 48 mm 48 x 48 mm 48 x 60 mm 48 x 76 mm 60 x 60 mm (TJ210) 60 x 76 mm (TJ210)
	Two-part T-clamp, heavy version Particular solid T-clamp with two bolts for an extra sturdy construction. Size A x B 48 x 48 mm 48 x 60 mm 60 x 60 mm 60 x 76 mm
	Four-way clamp Size A x B x C 48 x 48 x 48 mm 48 x 60 x 48 mm 48 x 76 x 48 mm 60 x 60 x 60 mm 60 x 76 x 60 mm
	Two-part T-clamp, model Frisia Size A x B 60 x 60 mm 60 x 76 mm
	Four-way clamp, model Frisia Size A x B x C 60 x 60 x 60 mm 60 x 76 x 60 mm
01.90.150 01.90.200 01.90.250 11.11.220 10.15.610 10.20.610 10.25.610	Fastener for retainer bar at the rear edge of the stall floor Fastener for retainer bar 48 mm Fastener for retainer bar 60 mm Fastener for retainer bar 76 mm Floor anchor bolt M10 x 86 (2 per fastener) Retainer bar (tube with reduced end part), working length 5.90 m Diameter 48 mm Diameter 60 mm Diameter 76 mm

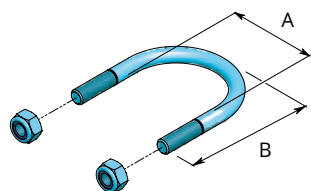

Threaded strap

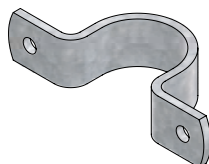

Mounting clip

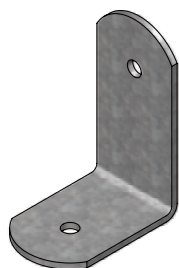

Angle support

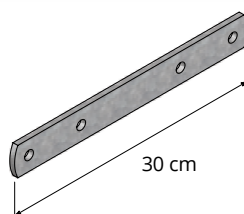

Connecting piece for wooden parts

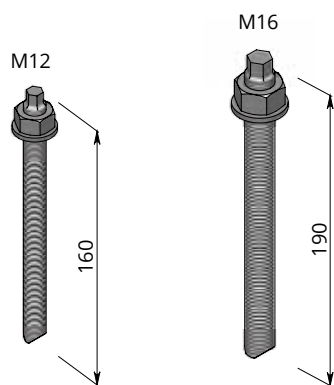

Anchor rod, standard

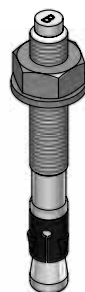

Floor anchor

item-no.	type	L (mm)	Bore Ø	L (mm)	Nm
11.12.012	M 12	95	14	110	30
11.12.016	M 16	95	18	125	60

04.53.065 04.53.085 04.55.075 04.56.090 04.57.250 04.66.090 04.80.110	Threaded strap Threaded strap M10, galvanized, nuts included. Size A x B 34 x 65 mm 34 x 85 mm 48 x 75 mm 60 x 90 mm 76 x 105 mm 60 x 90 mm 80 x 110 mm
	Threaded strap M12 Threaded strap M12, galvanized, nuts included. Maat A x B 60 x 90 mm
04.18.010 04.18.015 04.18.020 04.18.025 04.18.030 04.18.050 04.18.055 04.18.040 04.18.060 04.18.080 04.18.110	Mounting clip 34 mm 48 mm 60 mm 76 mm 89 mm 102 mm 108 mm 114 mm 60 x 60 mm 80 x 80 mm 80 x 120 mm
04.28.100	Angle support For fastening wooden front to the floor, etc. Size 10 x 14 cm
02.96.030	Connecting piece for wooden parts For connecting wooden parts underneath the feed front.
11.11.210 11.11.220 11.11.230 11.11.240 11.11.250	Floor anchor Steel anchor bolt. Characteristics: • Hot dip galvanized; • Self-locking; • Bolt diameter = drill diameter; Diam. x length M10 x 71 mm M10 x 86 mm M12 x 86 mm M12 x 106 mm M16 x 120 mm
11.11.420 11.11.430 11.11.440 11.11.450	Stainless Steel floor anchor Characteristics: • Stainless Steel inox A4; • Self-locking; • Bolt diameter = drill diameter. Diam. x length M10 x 86 mm - inox A4 M12 x 86 mm - inox A4 M12 x 106 mm - inox A4 M16 x 120 mm - inox A4
11.12.012 11.12.016	Chemical anchors Concrete anchor, consisting of mortar capsule and hot dip galvanized rod. Characteristics: • No pre-stress in concrete; • Very suitable for our floor mounted support posts; Standard model M12, incl. capsule (10 anchors) M16, incl. capsule (10 anchors)



“Choose Spinder, choose
100% Dutch quality”

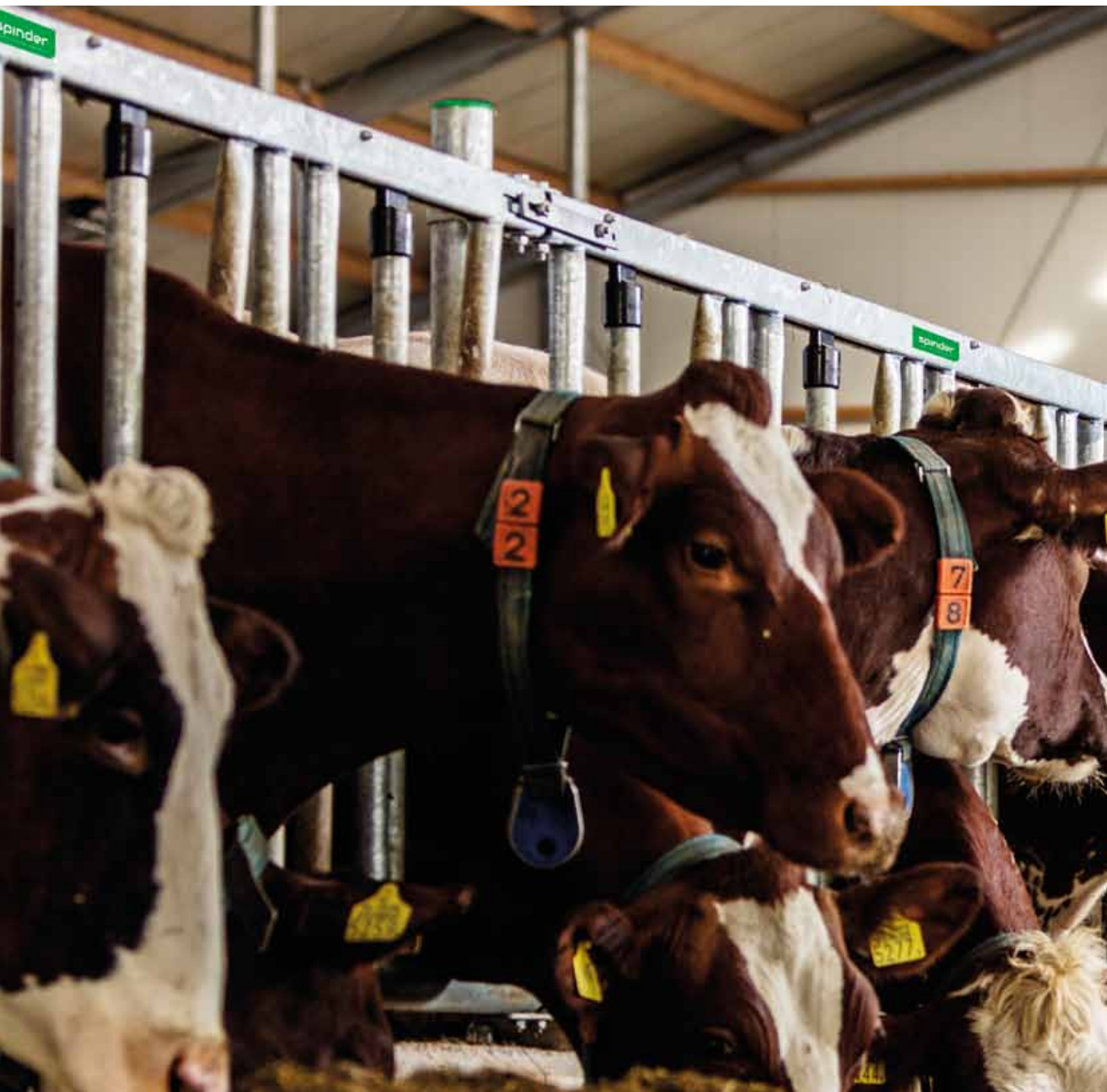

spinder
DAIRY HOUSING CONCEPTS

Zeppelinlaan 3
9207 JG Drachten
The Netherlands

☎ 00 31 (0)512 - 237800
E-mail: sales@spinder.nl
Website: spinderdhc.com

